

Jill never told him she was kick^{ed} out - he just thought
shot because he had told her what (she was a whore)
would happen if she didn't co-operate (he carried out those threats)

All of the children wanted to go home

Kept them until he was bored with them wanting to
~~go home~~ leave

death was secondary - it had to be ^{BRAZENLY} ^{CARRIED} out
so kidnapping - rape + murder

Reason they were on the left side because of the way
they were pick^{ed} out of car (legs under right arm, ^{Head} legs under left arm)

Tim was his ^{FAVORITE} because he played ball - had a
newspaper route - was bright - would have kept
him longer but heat was really on - reason for Wayne
was because they were stoppin' almost every car
in Oakland

Kristine - was just a very pleasant good nature^{ed} child
he was fond of her ^{lets why he} even busy here lightly in snow
Buried

If you have been bad and if you clean + neat
it makes it good -

Manna falling from heaven as they looked
for the promised land

What I spent, I had; what I saved, I lost;
what I gave I have, so the dead would
tell us if they spoke to us out of the dust

Killings stopped because he was smart enough
to know he couldn't get away with it again

Why take such good care of them & then kill them? Because
he had nothing personal against them, he killed them to
send this message

Why clean ^{them up} presenting package to world

- why not ask for ransom money - wasn't issue

- outwitting the Police Dept

1st time. I ask^{ed} did you kill those children
(and - why you want to be James?)

Say what do you suppose would happen to him if he caught

Friends

at Bro Rice ~~together~~ ^{were always present} at the same time and had
to clean the toilets

Although

Altho his apt has a lot of storage - he has a very small closet office at New Start on 5th street where he had hidden a plastic box containing dissecting and also black powder with manicure eg

Also has bag used nylons and many new nylons
I have pc of Bark wrap in parking spiders print

"work in storage
clothing"

(But not the wine etc)

He has book collection on serial murder
He has seen every movie on ^{Dr} subject of Serial Killings
He compares these crimes to the ock and comment
none were as cleverly planned & executed
Comments that

Social & Economic Problem and the act was justified

His worship of Hitler seems to be symbolically
(representative) of his own justifications for what
(representative) ~~the~~ killer did, that is, that the
social & economic problems justified the taking
of human life.

Just making me think about things I don't want to

Didnt want to kill them but had to because
they could do ruin

Now involved with something else secret
so it satisfies his mind (is writing a book)

What has told me that I'm not sure about
1st vacant home of his parents

Location: ~~Hot~~ Stable by Novi friend rented house in winter
HORSE

^{then}
Sleeping Drug placed in Refs to mother

How abducted - $\begin{matrix} \text{Z} & \text{Z} & \text{Z} \\ \text{O} & \text{O} & \text{O} \end{matrix}$ 1- ~~Disguise~~ Disguise
2- threat that he had gun
3- just talking kind

{ Bite on Tim's tongue could have been made by
{ Love Mutsu

{ Hair by Tim could have been left by animal who took
{ Chicken bones out of pocket
or by ^{Afghan} dog that intentionally placed ~~them~~ ^{the hair} ~~in the~~ ^{from} ~~body~~

= Dog belongs to an Arabic or Caldean man name
- who lived in Rosedale Park

and worked with at Biff's - he owned a light blue
Grand Prix which I used - the man was a Homo

TAB # 3

Hastings Maps

1992 - Birmingham PD
Report # 1 -

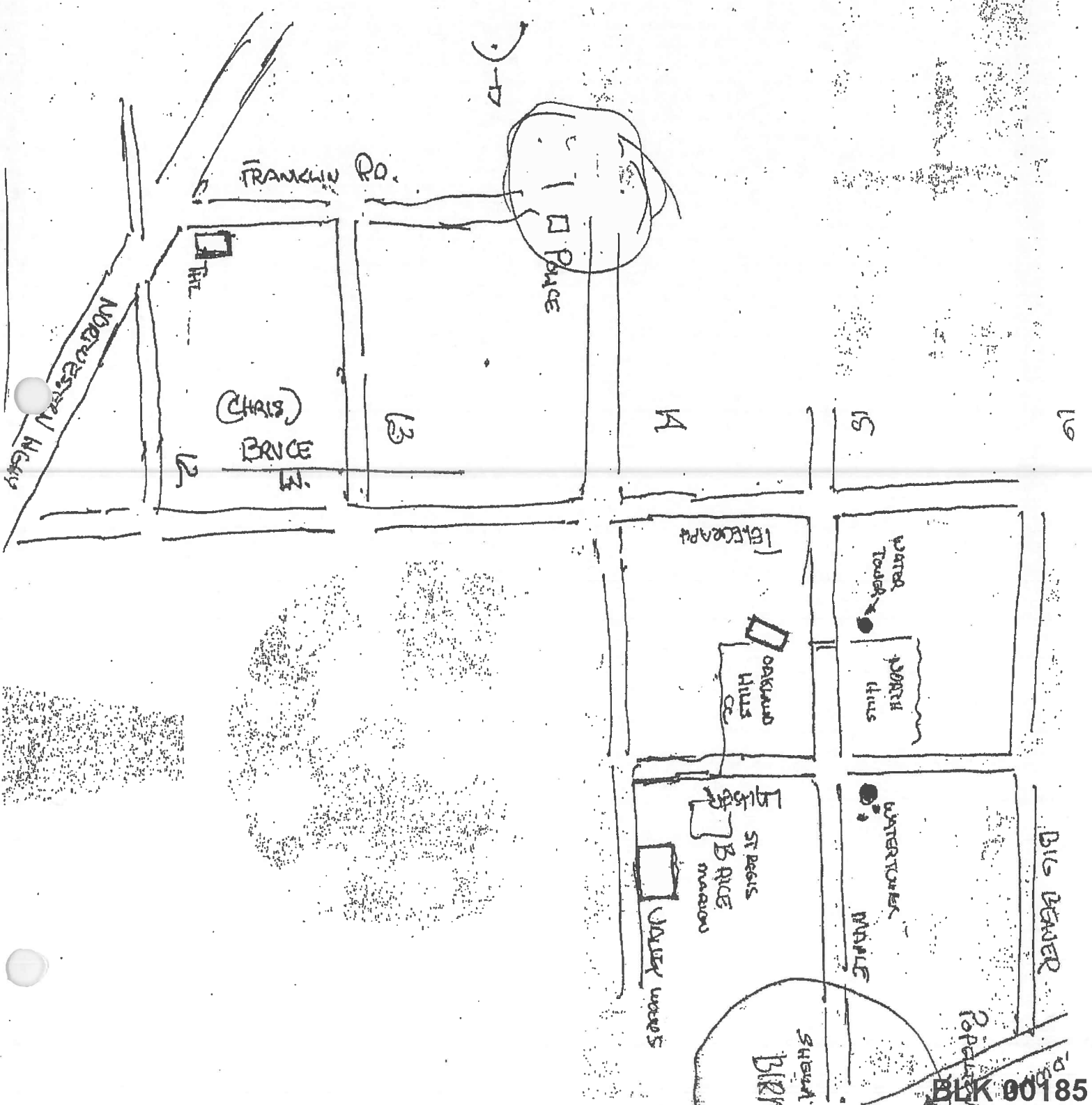

John
Jan 10

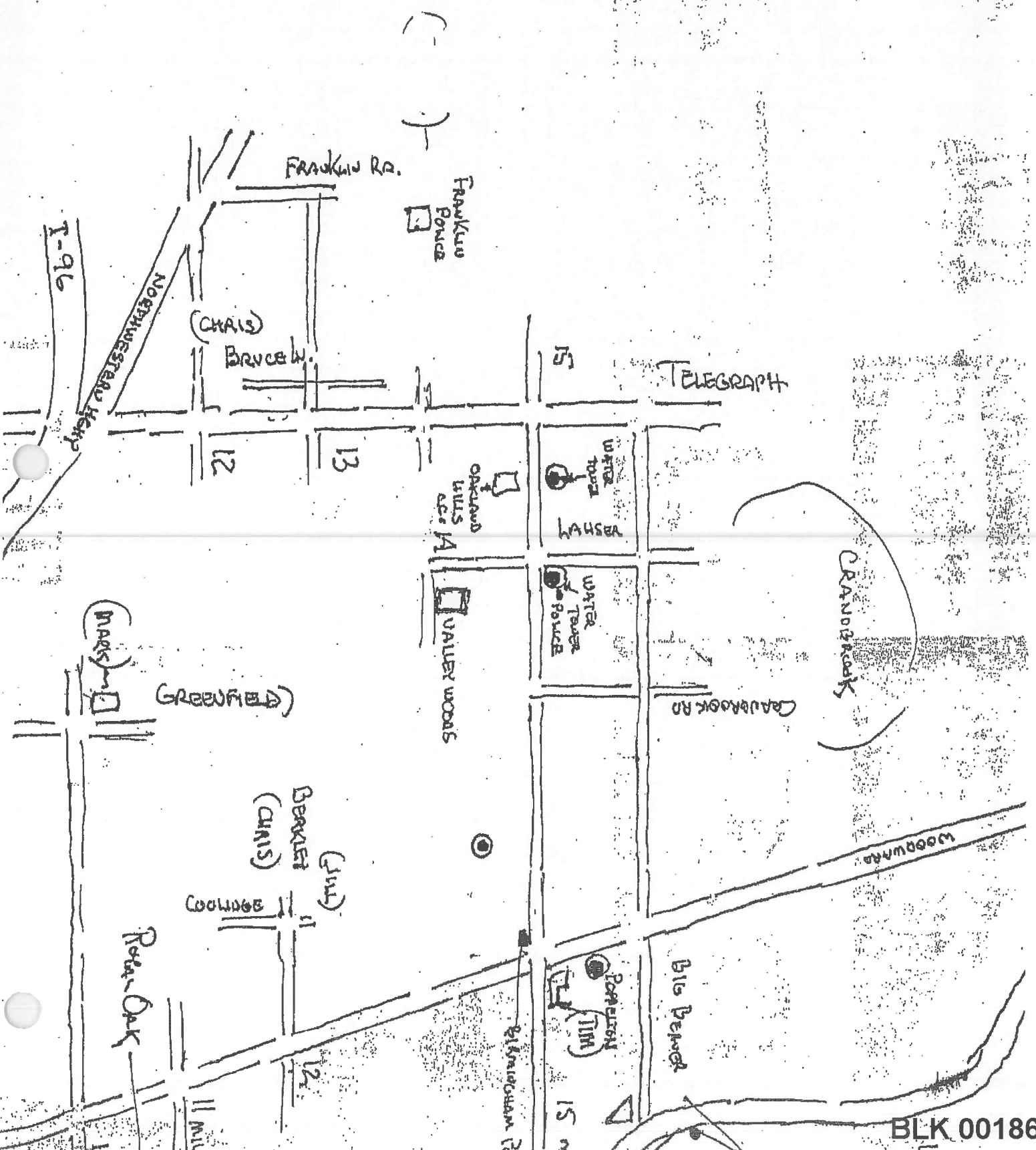

BLK 00186

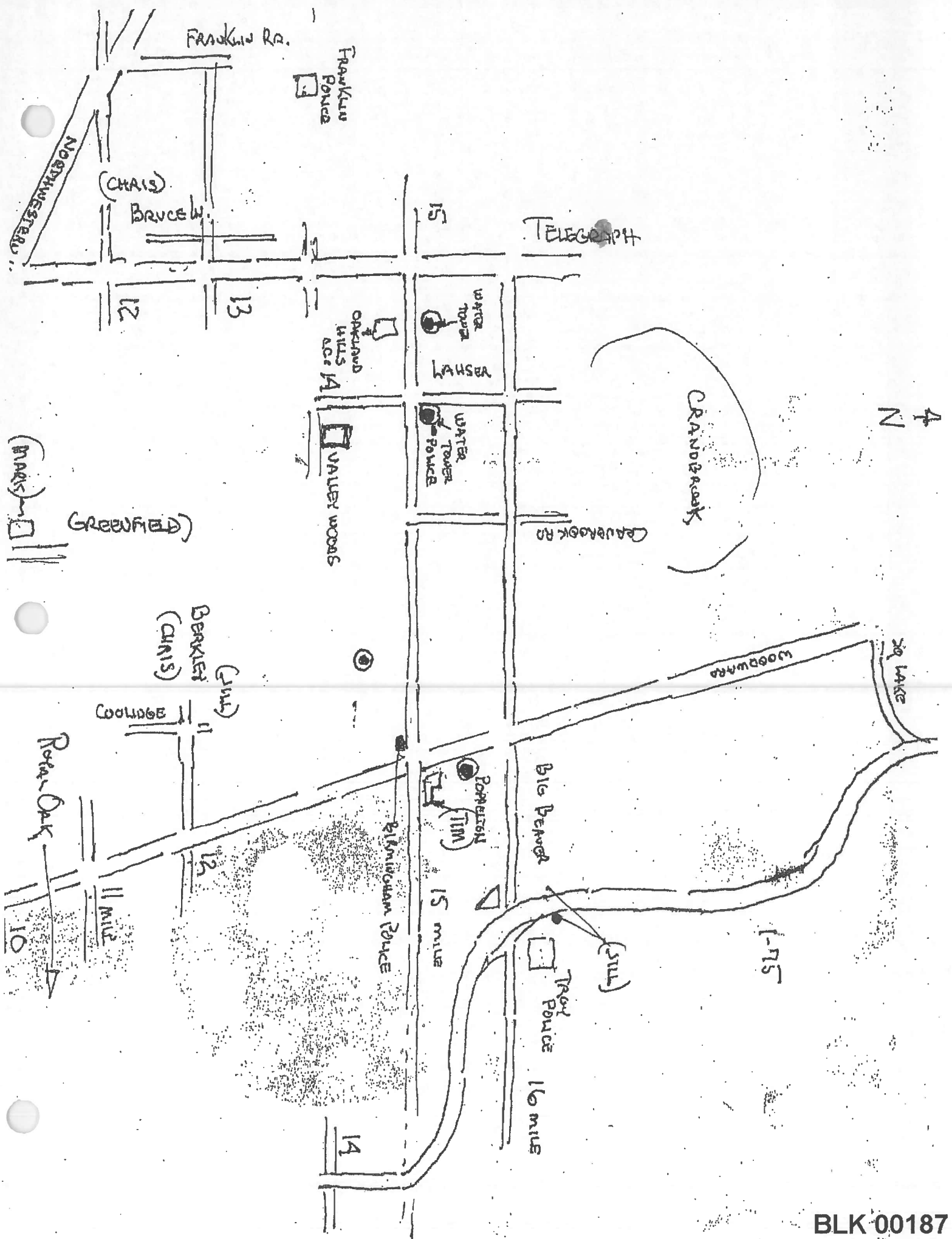

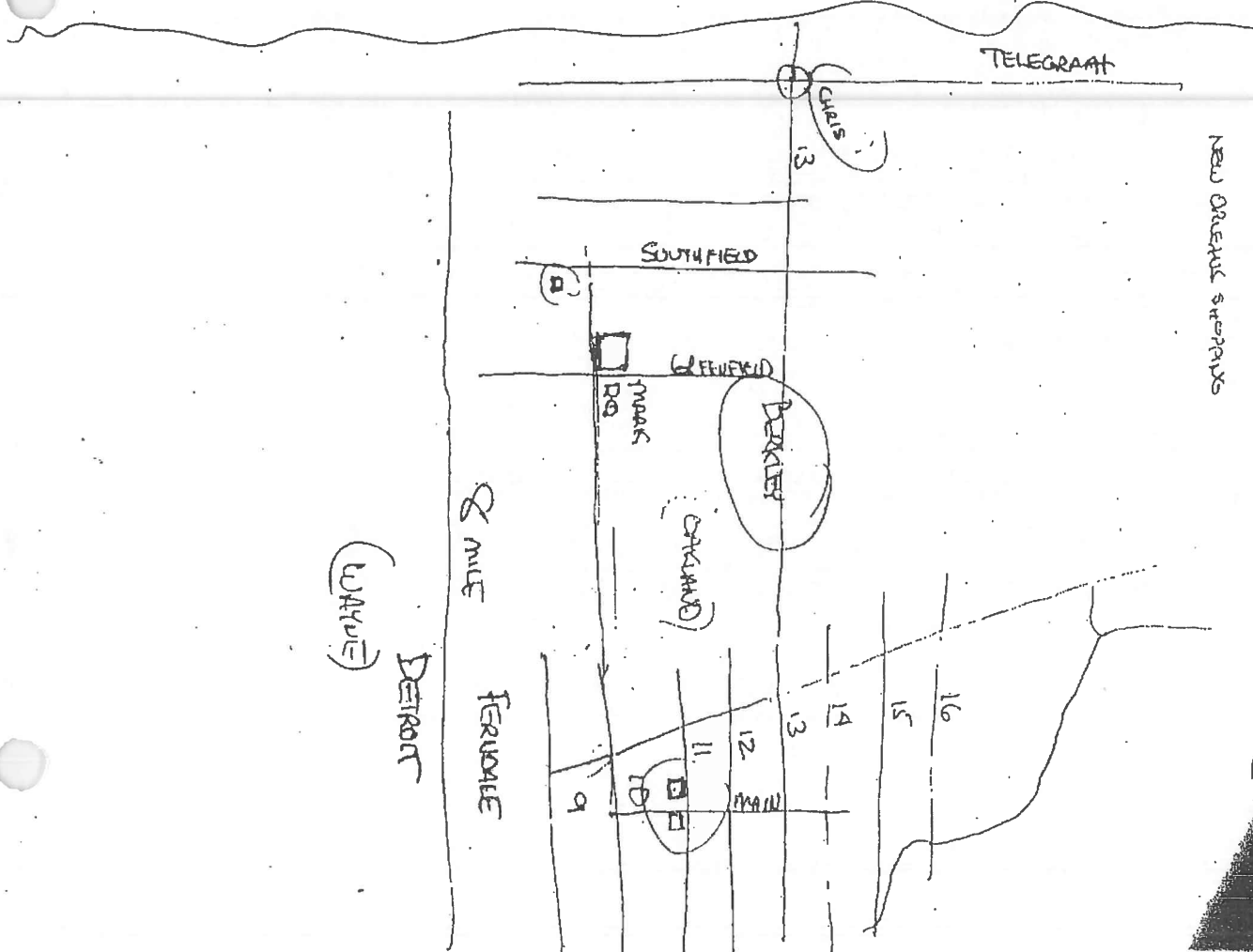
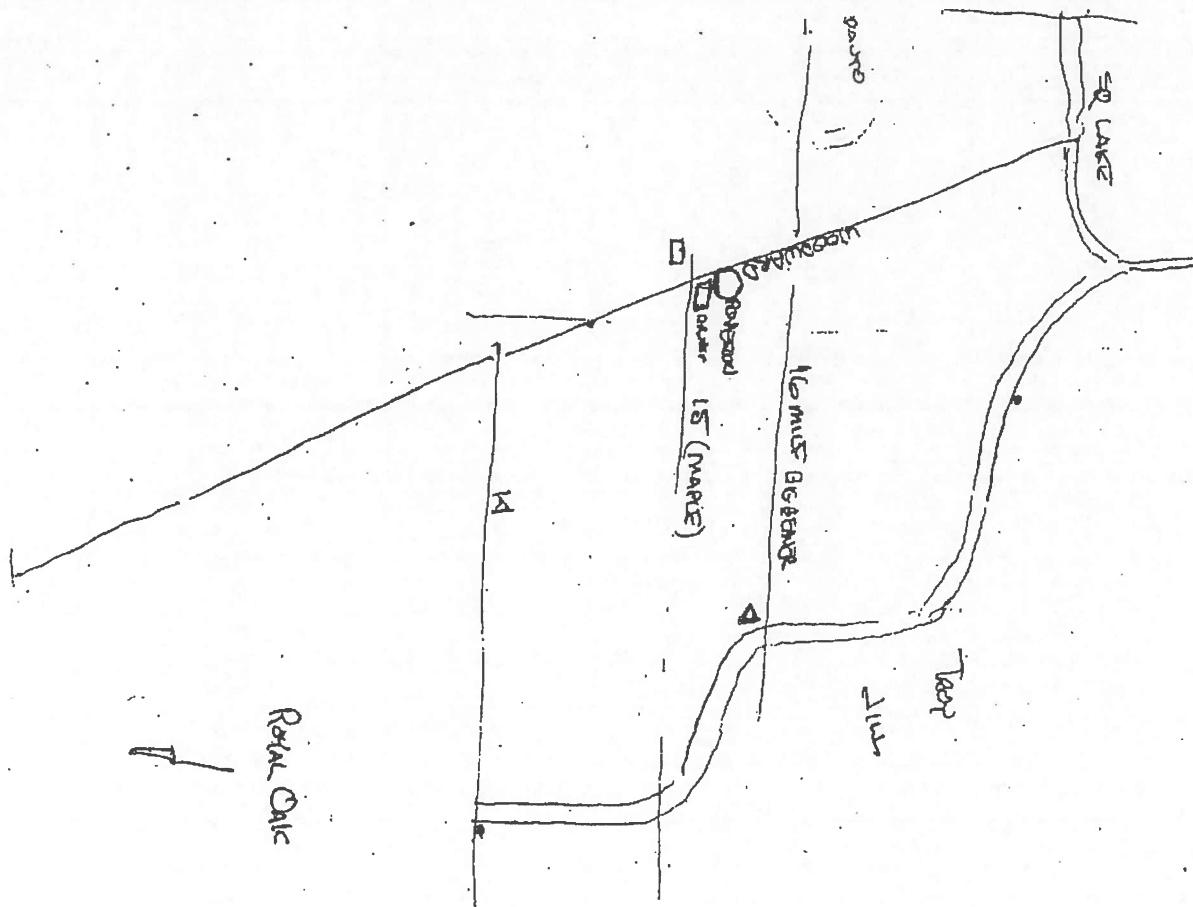

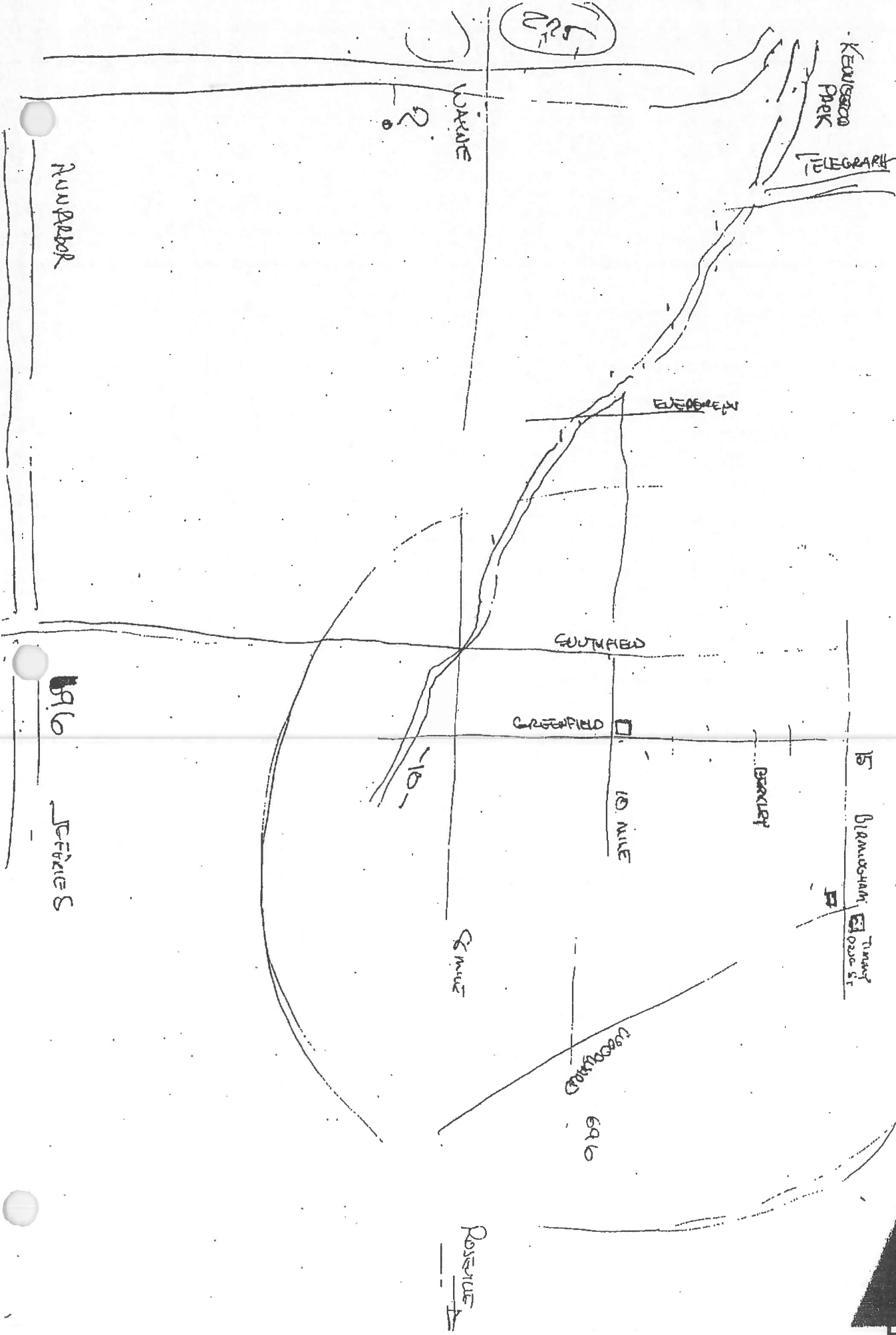

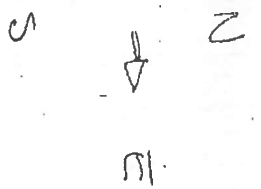

Bloomfield

Pennac

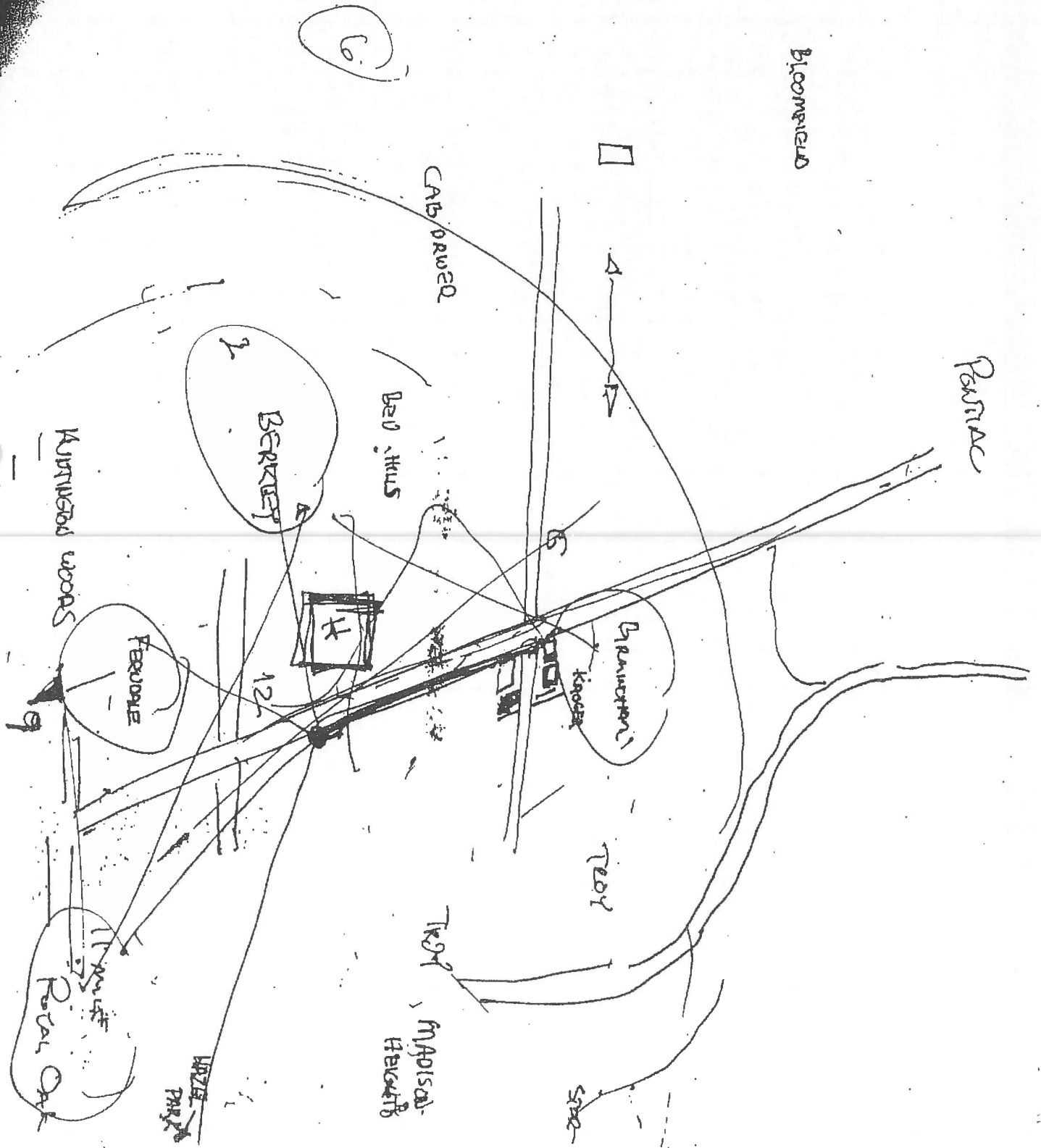

TAB #4

Hastings-Europe

1992 Birmingham PD
Report #1

INTERNATIONAL CRIMINAL POLICE ORGANIZATION
INTERPOL
U.S. NATIONAL CENTRAL BUREAU
TELEFAX - TRANSMITTAL SHEET

PRIORITY: IMPCIRTANT

DATE: 31 March 92

PAGES TRANSMITTED (TOTAL): 2

TO (NAME): COMMANDER DONALD A. STUDD
ORGANIZATION: BIRMINGHAM MI. PD

YOUR FAX#: 313-644-5614

YOUR PHONE#: 313-644-3405

YOUR REFERENCE: #77-333

SUBJECT(S) NAME:

DATE OF BIRTH: 11 OCTOBER 1949
PLACE OF BIRTH:
ALIA:(ES):

FROM: HUGH K. DARDEN, SPECIAL AGENT
INTERPOL/USNCB CASE#: 92-03-01107/HKD
MESSAGE/INSTRUCTION:

REFERENCE IS MADE TO YOUR MESSAGE DATED 03 MARCH 1992.
ATTACHED IS A MESSAGE FROM INTERPOL FRANCE DATED 28 MARCH
1992.

IF YOU HAVE ANY QUESTIONS, PLEASE CONTACT SA KEN DARDEN AT 202-
272-8383.

REGARDS.

OPERATOR'S INITIALS:

U. S. DEPARTMENT OF JUSTICE
INTERPOL - USNCB
WASHINGTON, DC 20530

TELEPHONE NO: (202) 272-8383/FTS 272-8383
TELEFAX NO : (202) 272-5941/FTS 272-5941
PHOTOFAX NO : (202) 272-8148/FTS 272-8148
NLETS ORI: DCINTER00

BLK 00193

INTERNATIONAL CRIMINAL POLICE ORGANIZATION
INTERPOL
U.S. NATIONAL CENTRAL BUREAU

TELEFAX - TRANSMITTAL SHEET

PRIORITY: IMP(ORTANT

DATE: 31 March 92

PAGES TRANSMITTED (TOTAL): 2

TO (NAME): COMMANDER DONALD A. STUDD
ORGANIZATION: BIRMINGHAM MI. PD

YOUR FAX#: 313-644-5614

YOUR PHONE#: 313-644-3405

YOUR REFERENCE: #77-333

SUBJECT(S) NAME:

DATE OF BIRTH:

PLACE OF BIRTH:

ALIA(S):

FROM: HUGH K. DARDEN, SPECIAL AGENT

INTERPOL/USNCB CASE#: 92-03-01107/HKD

MESSAGE/INSTRUCTION:

REFERENCE IS MADE TO YOUR MESSAGE DATED 03 MARCH 1992.
ATTACHED IS A MESSAGE FROM INTERPOL FRANCE DATED 28 MARCH
1992.

IF YOU HAVE ANY QUESTIONS, PLEASE CONTACT SA KEN DARDEN AT 202-
272-8383.

REGARDS.

OPERATOR'S INITIALS:

U. S. DEPARTMENT OF JUSTICE
INTERPOL - USNCB
WASHINGTON, DC 20530

TELEPHONE NO: (202) 272-8383/FTS 272-8383
TELEFAX NO : (202) 272-5941/FTS 272-5941
PHOTOFAX NO : (202) 272-8148/FTS 272-8148
NLETS ORI: DCINTER00

BLK 00194

6
10

of Embuuk. I'm also
short of cash but I've been
having a wonderful time
I'm a short while I will
go to Florida and stay
with Tom. Talk to you
later about everything. Joe



U.S.A.
POSTAGE DUE

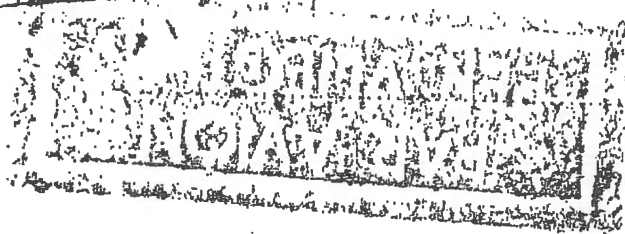

ing in Europe
was. We been
was, Holland
town. It's a bit
different lang-
uages are the
re is not good
at the winter
except in the
had to have ©
out you
thin 60 miles

Editions
DEMOL

BRUXELLES - BRUSSEL
 Grand'Place, Tapis de fleurs la nu
 Grote Markt, Bloementapit bij na
 Market Place, Flower carpet by rig
 Marktplatz, Blumen Teppich bei Nach
 Piazza Grande, Tappeto di fiori di notte

Hello

6/10

I've been thinking in Europe
 for about a month now. I've been
 to Italy, Switzerland, France, Holland
 and now Brussels, Belgium. It's a bit
 hard to pick up all these different lang-
 uages but I think the French are the
 easiest. The economy here isn't so good
 worse than the U.S. But the winter
 is very mild. Not snow except in the
 Alps. I would have liked to have
 gone to the Olympics but you
 can't find a room within 100 miles

of Embankment. I'm also
 short of cash but I've been
 running a wonderful store
 in a short while I will
 go to Florida and stay
 with
 Tell to you
 later about everything.

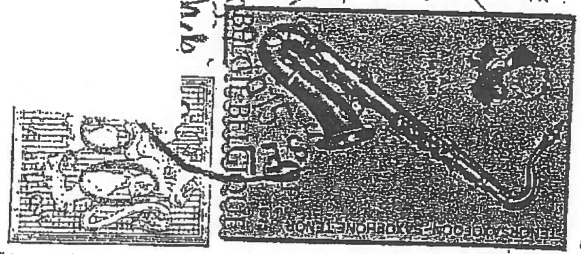

U.S.A.
 POSTAGE DUE
 48075

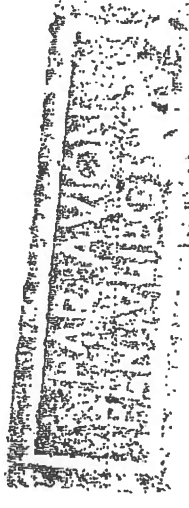

Editions
 DEMOIL

TAB # 5

Hastings - G.M. FILE

1992 Birmingham PD
Report # 1 - 3

CMND:
UNIT: 48029
SSN :

VIP 2000 PERSONNEL ON-LINE
EMPLOYEE PLANT HISTORY INQUIRY
PO/HISTI

DATE: 02/28/92
TIME: 09:06:53
USER: DJC1917
TERM: DJC1917
IMS : PROD
PAGE: 1 MORE

CURRENT OTHER
UNIT/MEMO: 48029
PLT SEN : 01/03/78
STATUS CD: R31
STATUS DT: 03/12/90

GM SEN: 01/03/78

PHONE:

STATUS	DATA	OCCP	DEPT	RATE	SHIFT	SUPV	
R31	JOBS-ATTACHMENT B-VTEP	03/12/90	1029	0347	14.010	2	00005
A05	RETURN 130 DAY LEAVE	12/04/89	1029	0347	14.010	2	00005
A04	SICK LEAVE	09/21/89	1029	0347	14.010	2	00005
A17	NO WRITTEN LEAVE	09/21/89	1029	0347	14.010	2	00005
I30	RATE CHANGE	10/26/87	1029	0347	14.010		00005
H04	RETURN FROM 130 DAY LEAVE	10/27/86	1029	0347	12.820	2	
A04	SICK LEAVE	10/16/86	1029	0347	12.820	2	
A17	NO WRITTEN LEAVE	10/16/86	1029	0347	12.820	2	
H08	HIRE FROM LAYOFF-SENIORITY	10/13/84	1029	0347	12.820	2	
L01	LAYOFF - REDUCTION IN FORCE	10/03/84	1029	1220	12.820	2	

PFKEY: 1/13=HELP 4/16=DEMO 5/17=MISC 7/19=RWD 8/20=FWD 24=MAIN

00380 - SCREEN IS FULL- PRESS ENTER FOR MORE INFORMATION

CMND:
UNIT: 48029
SSN :

VIP 2000 PERSONNEL ON-LINE
EMPLOYEE PLANT HISTORY INQUIRY
PO/HISTI

DATE: 02/28/92
TIME: 09:07:00
USER: DJC1917
TERM: DJC1917
IMS : PROD
PAGE: 2 MORE

CURRENT OTHER
UNIT/MEMO: 48029
PLT SEN : 01/03/78
STATUS CD: R31
STATUS DT: 03/12/90

GM SEN: 01/03/78

PHONE:

STATUS	DATA	OCCP	DEPT	RATE	SHIFT	SUPV	
T01	TRANS-REDUCTION IN FORCE	08/13/84	1029	1220	12.820	2	
T01	TRANS-REDUCTION IN FORCE	08/12/84	1029	1400	12.820	2	
T01	TRANS-REDUCTION IN FORCE	08/11/84	1029	1405	12.820	2	
H04	RETURN FROM 130 DAY LEAVE	07/21/84	1029	1220	12.820	2	
A04	SICK LEAVE	07/08/84	1029	1220	12.820	2	
A17	NO WRITTEN LEAVE	07/08/84	1029	1220	12.820	2	
T01	TRANS-REDUCTION IN FORCE	07/16/84	1029	1220	12.820	2	
T30	RATE CHANGE	10/15/84	1029	0921	12.820	2	
T45	LOCAL SHIFT PEF AGMT 5	02/27/84	1029	0921	9.630	2	
H08	HIRE FROM LAYOFF-SENIORITY	02/20/84	1029	0921	9.630	1	

PFKEY: 1/13=HELP 4/16=DEMO 5/17=MISC 7/19=RWD 8/20=FWD 24=MAIN

00380 - SCREEN IS FULL- PRESS ENTER FOR MORE INFORMATION

CMND:
UNIT: 48029
SSN :

VIP 2000 PERSONNEL ON-LINE
EMPLOYEE PLANT HISTORY INQUIRY
PO/HISTI

DATE: 02/28/92
TIME: 09:07:10
USER: DJC1917
TERM: DJC1917
IMS : PROD
PAGE: 3 END

CURRENT OTHER
UNIT/MEMO: 48029
PLT SEN : 01/03/78
STATUS CD: R31
STATUS DT: 03/12/90

GM SEN: 01/03/78

PHONE: 317-407

STATUS	DATA	OCCP	DEPT	RATE	SHIFT	SUPV	
L01	LAYOFF - REDUCTION IN FORCE	03/25/82	1029	1166	9.630	2	
T02	DEPT-FACT NUMBER CHANGED	10/08/81	1029	1166	9.630	2	
T30	RATE CHANGE	09/14/81	1029	1100	9.630	2	
H08	HIRE FROM LAYOFF-SENIORITY	04/13/81	1029	1100	9.630	2	
L01	LAYOFF - REDUCTION IN FORCE	08/21/80	1029	0921	9.080	1	
H04	RETURN FROM 130 DAY LEAVE	08/18/80	1029	0921	9.080		
A04	SICK LEAVE	08/11/80	1029	0921	9.080		
H08	HIRE FROM LAYOFF-SENIORITY	02/12/80	1029	0921	9.080		
L01	LAYOFF - REDUCTION IN FORCE	12/14/79	1029	1502	9.080		
T30	RATE CHANGE	10/01/79	1029	1502	9.080		

PFKEY: 1/13=HELP 4/16=DEMO 5/17=MISC 7/19=RWD 8/20=FWD 24=MAIN

00381 - ALL INFORMATION DISPLAYED- ENTER NEXT REQUEST

BASIC INFORMATION : 376521503

GRID... N15

0000000

SS 376 52 1503

SEX M

BIRTH

5

IN

FORM OCCUPO000 00

SEN 01/03/78

VAC 01/03/78

HIRE 01/03/78

NXT INC

99/99

CONV 99/99

EDUC P

TRANSACTIONS FOR :

0000000

TRAN CODE	EFF DATE	CLOCK NUMBER	RATE	OCCUP CODE	TYP SEN	LO/LV DATE	SKL CODE	SKL/SEN DATE	MAS CODE	DIV	OCCUPATION DESCRIPTION
U1	08/21/80	092113	09.08	0002 01	2	00/00		01/03/78	1	B	ASSEMBLER
C4	08/18/80	092113	09.08	0002 01	2	00/00		01/03/78	1	B	ASSEMBLER
Z3	08/11/80	092113	09.08	0002 01	2	00/00		01/03/78	1	B	ASSEMBLER
B1	02/12/80	092113	09.08	0002 01	2	00/00		01/03/78	1	B	ASSEMBLER
U1	12/14/79	150279	09.08	0002 01	2	00/00		01/03/78	1	R	ASSEMBLER
J8	10/01/79	150279	09.08	0002 01	2	00/00		01/03/78	1	R	ASSEMBLER
C4	06/28/79	150279	07.30	0002 01	2	00/00		01/03/78	1	R	ASSEMBLER
Z3	06/18/79	150279	07.30	0002 01	2	00/00		01/03/78	1	R	ASSEMBLER
C4	05/30/79	150279	07.30	0002 01	2	00/00		01/03/78	1	R	ASSEMBLER
Z3	03/20/79	150241	07.30	0002 01	2	00/00		01/03/78	1	R	ASSEMBLER
P1	11/01/78	150241	07.30	0002 01	2	00/00		01/03/78	1	R	ASSEMBLER
J8	09/18/78	150135	07.30	0002 01	2	00/00		01/03/78	1	R	ASSEMBLER
P1	09/08/78	150135	07.09	0002 01	2	00/00		01/03/78	1	R	ASSEMBLER
P1	08/24/78	150255	07.09	0002 01	2	00/00		01/03/78	1	R	ASSEMBLER
J2	04/03/78	150873	07.09	0002 01	2	00/00		01/03/78	1	R	ASSEMBLER
N2	04/02/78	150373	06.84	0002 01	2	00/00		01/03/78	1	R	ASSEMBLER
J2	02/06/78	150373	06.84	0002 01	0	00/00		01/03/78	1	R	ASSEMBLER
A1	01/03/78	150373	06.64	0002 01	0	00/00		01/03/78	1	R	ASSEMBLER

DISCIPLINARY ACTIONS FOR :

0000000

DATE	MONTH	TYPE ACTION	RULE NO.
07/23/80	H	AVO	011
08/03/78	H	ONE WEEK	011
07/26/78	F	BAL + TWO DAYS	011
04/18/78	D	AVO	011

RATINGS FOR :

0000000

DATE	QUAN	QUAL	ABIL	COOP	ATTN	SAFE	PERS
08/21/80	A	A	A	A	A	A	A
08/24/78	A	A	A	A	A	A	A

TAB # 6

Broth RICE Bloomfield Twp
PD

1992 Birmingham PD
Report # 1 -

(17)